

# SHIMANO

## BAITRUNNER A-RB

## BTR-6500B

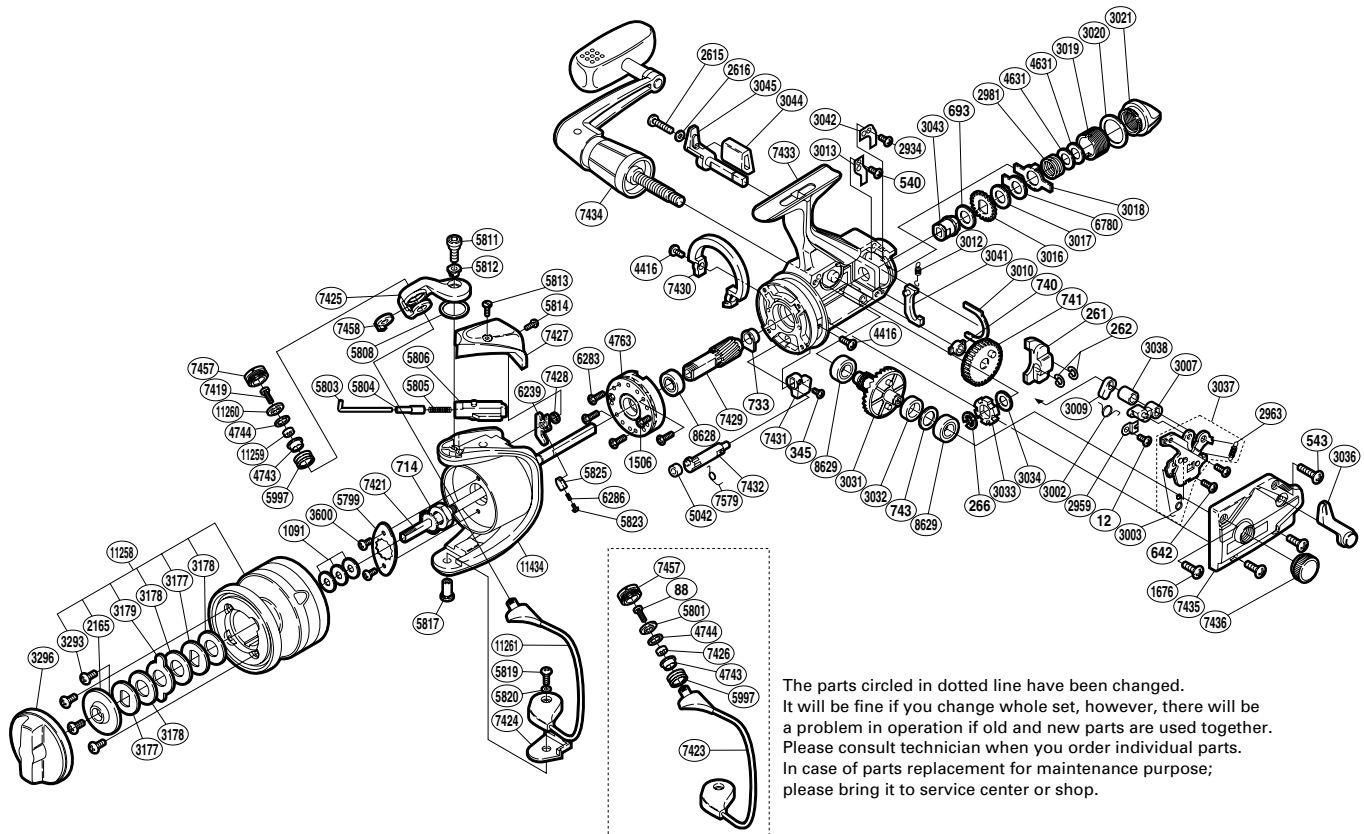

The parts circled in dotted line have been changed. It will be fine if you change whole set, however, there will be a problem in operation if old and new parts are used together. Please consult technician when you order individual parts. In case of parts replacement for maintenance purpose; please bring it to service center or shop.

(1SD996502U)

Part No.	Description	Part No.	Description	Part No.	Description
RD 0012	Shaft Retainer Screw	RD 3031	Drive Gear	RD 5823	Lever Spring Guide (A)
RD 0261	Oscillating Slider	RD 3032	Drive Gear Spacer	RD 5825	Lever Spring Guide (B)
RD 0262	"C" Lock	RD 3033	BaitRunner Ratchet	RD 5997	Line Roller
RD 0266	"C" Lock	RD 3034	Ratchet Spacer	RD 6239	Bail Trip Lever
RD 0345	Anti-Reverse Lever Screw	RD 3036	BaitRunner Lever Arm (L)	RD 6283	Roller Clutch Screw
RD 0540	Pawl Guide Screw	RD 3037	Clutch Plate Assembly	RD 6286	Bail Trip Lever Spring
RD 0543	Side Cover Screw (B)	RD 3038	Clutch Cam Spacer (A)	RD 6780	Single Eared Washer
RD 0642	Clutch Plate Screw	RD 3041	BaitRunner Pawl	RD 7419	Line Roller Screw
RD 0693	Free Spool Tension Washer (A)	RD 3042	Dial Click	RD 7421	Main Shaft
RD 0714	Rotor Nut	RD 3043	Free Spool Tension Shaft	RD 7424	Bail Hold Support Spacer
RD 0733	Pinion Gear Bushing	RD 3044	BaitRunner Lever Bridge	RD 7425	Bail Arm
RD 0740	Oscillating Gear Bushing	RD 3045	BaitRunner Lever Arm (R)	RD 7427	Bail Spring Cover
RD 0741	Oscillating Gear	RD 3177	Key Washer	RD 7428	Bail Trip Lever Washer
RD 0743	Washer	RD 3178	Drag Washer	RD 7429	Pinion Gear
RD 1091	Spool Washer	RD 3179	Eared Washer	RD 7430	Friction Ring
RD 1506	Roller Clutch Cover Screw	RD 3293	Seal Plate Screw	RD 7431	Anti-Reverse Lever
RD 1676	Side Cover Screw (A)	RD 3296	Drag Knob	RD 7432	Anti-Reverse Cam
RD 2165	Seal Plate	RD 3600	Nut Lock Screw	RD 7433	Body
RD 2615	BaitRunner Lever Screw	RD 4416	Friction Ring Screw	RD 7434	Handle Assembly
RD 2616	Lock Washer	RD 4631	Tension Spring Washer "B"	RD 7435	Side Cover
RD 2934	Dial Click Screw	RD 4743	Line Roller Bushing	RD 7436	Handle Screw Cap
RD 2959	Lever Shaft Retainer	RD 4744	Roller Bearing Seal	RD 7457	Line Roller Screw Cap
RD 2963	BaitRunner Click Spring	RD 4763	Roller Clutch Assembly	RD 7458	Line Roller Support Collar
RD 2981	Free Spool Tension Spring	RD 5042	Anti-Reverse Cam Ring	RD 7579	Anti-Reverse Cam Spring
RD 3002	Clutch Spring	RD 5799	Rotor Nut Retainer	RD 8628	Ball Bearing
RD 3003	Clutch Pawl Spring	RD 5803	Bail Spring Guide (A)	RD 8629	Ball Bearing
RD 3007	Clutch Arm	RD 5804	Spring Guide (A) Support	RD11258	Spool Assembly
RD 3009	Clutch Cam	RD 5805	Bail Spring	RD11259	Line Roller Collar
RD 3010	Dial Retainer	RD 5806	Bail Spring Guide (B)	RD11260	Line Roller Washer
RD 3012	BaitRunner Pawl Spring	RD 5808	Bail Arm Washer	RD11261	Bail Assembly
RD 3013	BaitRunner Pawl Guide	RD 5811	Bail Arm Screw	RD11434	Rotor
RD 3016	Click Gear	RD 5812	Bail Arm Screw Collar		
RD 3017	Free Spool Tension Washer (B)	RD 5813	Guard Screw (A)		
RD 3018	Eared Washer "Bfs"	RD 5814	Guard Screw (B)	RD 0088	Line Roller Screw (before change)
RD 3019	Free Spool Tension Screw	RD 5817	Bail Hold Support Shaft	RD 5801	Line Roller Washer (before change)
RD 3020	Dial Spacer	RD 5819	Bail Hold Support Screw	RD 7423	Bail Assembly (before change)
RD 3021	BaitRunner Tension Dial	RD 5820	Spacer	RD 7426	Line Roller Collar (before change)

(190315)